



CIRCULATION
675 SF

3,393 SF

9,456 SF

1,500 SF

1,500 SF

1,600 SF

74'-0"

20'-0"

20'-0"

20'-0"

TOTAL GROSS:
18,124 SF



TOTAL GROSS:
18,124 SF



TOTAL GROSS:
18,124 SF

**PRELIMINARY
NOT FOR
REGULATORY
APPROVAL,
PERMITTING OR
CONSTRUCTION**

**KOURY
CORPORATION**
2275 VANSTORY ST
GREENSBORO NC
27403

**SAWMILL VILLAGE
TUESDAY MORNING**
PROJECT NO. _____
BACONS BRIDGE ROAD, SUMMERSVILLE SC

**PROJECT
REVISIONS**

10.25.23
SCHEMATIC

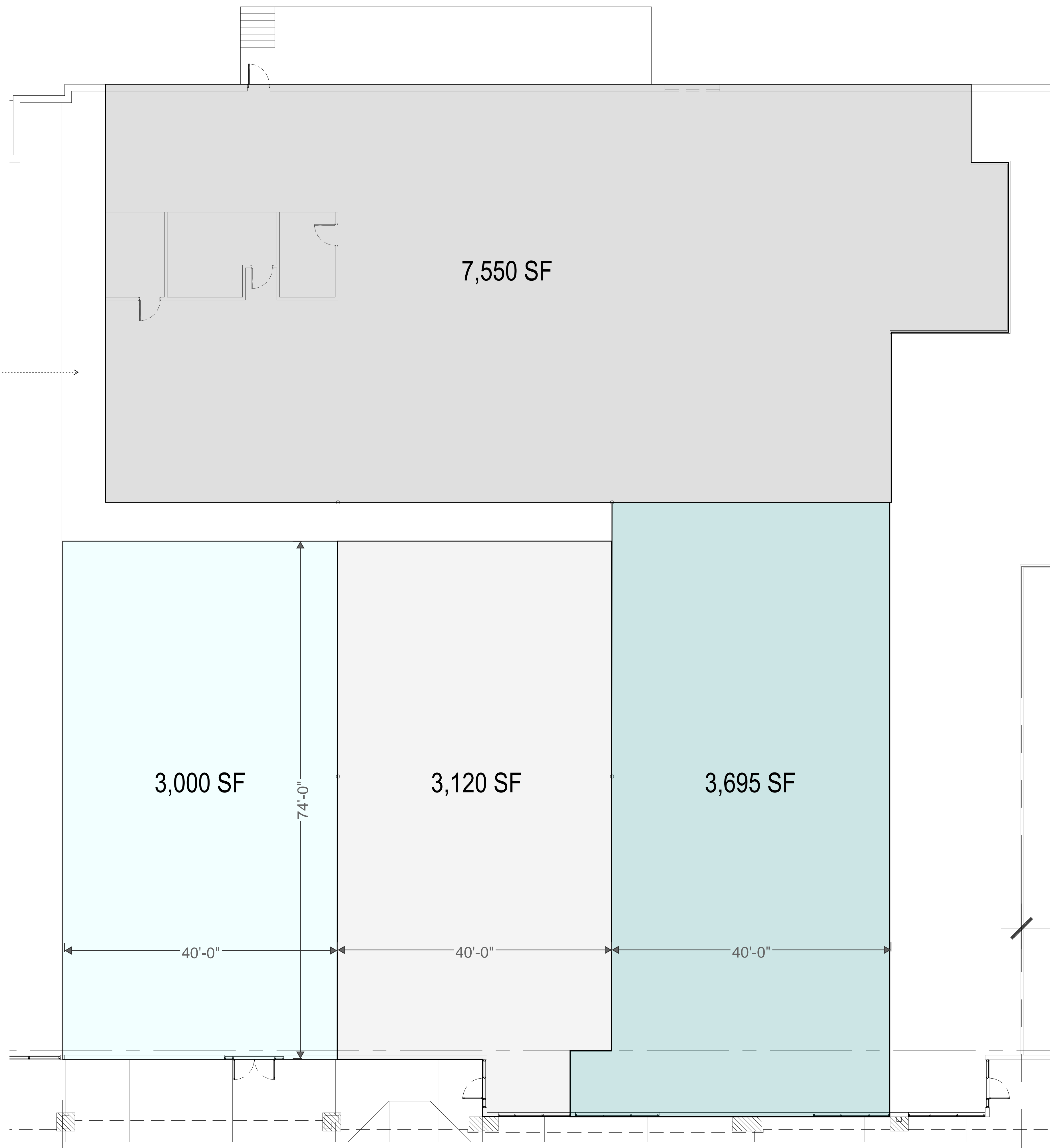

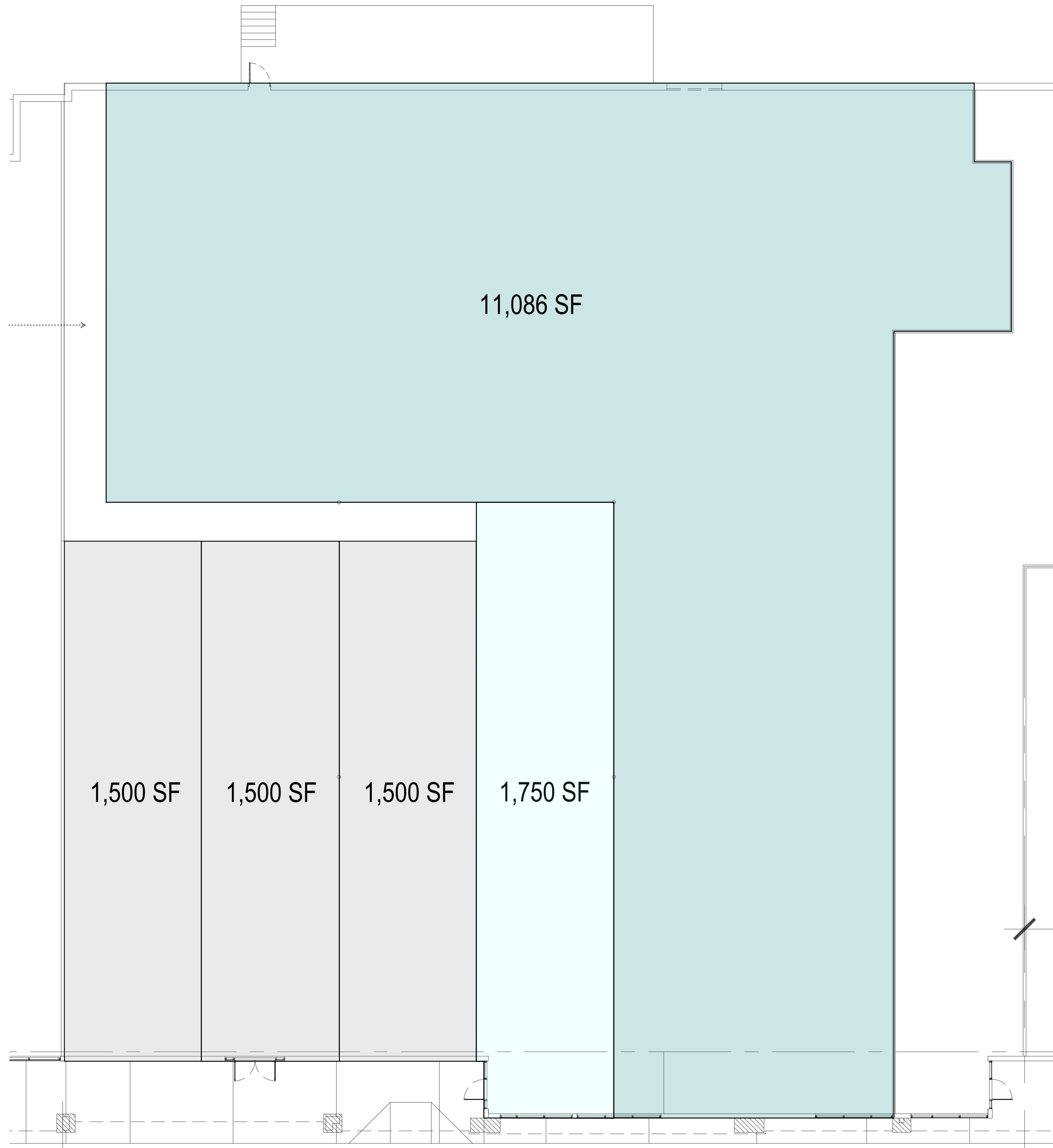

TOTAL GROSS:
18,124 SF